

Cor-Vet 4" Round Adjustable Downlight (102mm)

Core trims and mountings with Rivet light engine and adjusting
Adjustable Recessed Accent/Downlight

The Core Family meets the Rivet Family

Linking the timeless style and elegance of the Core fixture trims with the precision adjusting of the Rivet light engine, we form the Cor-Vet. The core trims offer 3 aperture options in 14 standard finishes, custom color match, RAL or our renowned custom wood trims. The Rivet light engine brings a precision engineered dual axis cam for 36° tilt hot aiming and a unique magnetic head mounting for easy 360° rotation. With a toolless drop down of the optic assembly for quick media placement, you can easily shape the finely tuned static white and Ambient Dim (warm dim) sources with up to 2 pieces of media. You have found the Round Cor-Vet 4" Adjustable Downlight and hope you enjoy the details.

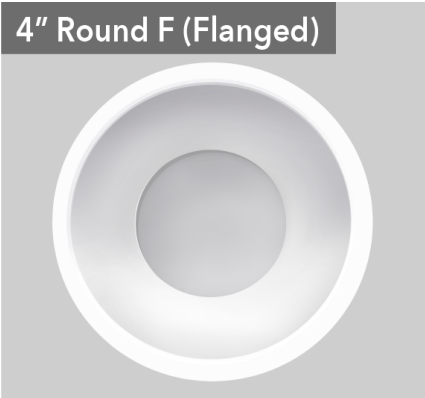
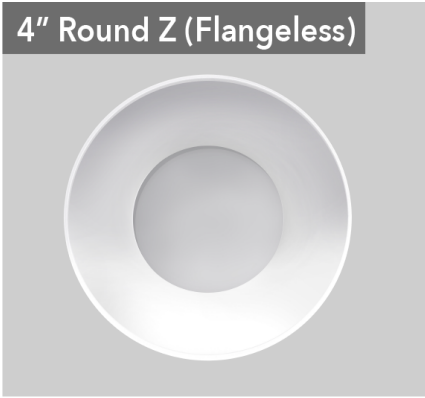

Deep Regress shown

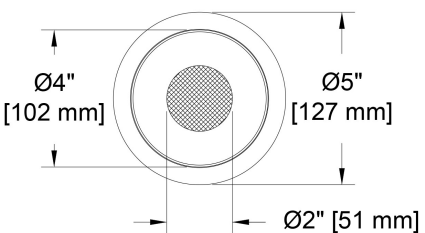
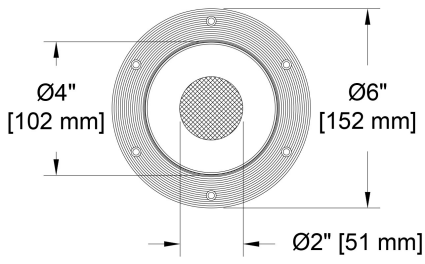

Aperture Options



Deep Regress (DR)
2" Optical Aperture
Formerly known as 1001



FL- Flat (Pin Hole)
2" Optical Aperture
Formerly known as 1000

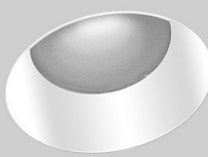

Open Regress (OR)
3" Optical Aperture
Formerly known as 1016



Wood Finish
All apertures options

ROUND Beamspreads	System watts (W)	20°				28°				40°			
		Delivered Lumens (lm)	Lumens/ Watt	Peak CD	10% Field	Delivered Lumens (lm)	Lumens/ Watt	Peak CD	10% Field	Delivered Lumens (lm)	Lumens/ Watt	Peak CD	10% Field
Citizen C7	9	696	82	3520	48°	632	74	2101	52°	644	76	1143	54°
Citizen C11	13	965	77	4962	48°	875	69	2918	52°	888	70	2046	54°
Ambient Dim A9	10	547	54	2145	50°	484	48	1358	54°	514	51	1166	54°
Ambient Dim A11	12	629	52	2470	50°	565	47	1603	54°	592	49	1341	53°

Ambient dim measured at full output. ISO cd Plots based upon C11 Source. Refer to photometry tab on product page for exact ISO cd plot and IES files. Data is based upon a single head aimed at 0°.

PROJECT:

TYPE:

SPECIFIER:

DATE:

Key Points (CRV4D-RA)

Trim

- One-piece die cast aluminum or machined wood trim
- Flangeless includes plaster flange with lip
- 14 color options + custom RAL or wood available
- Flanged or Flangeless

Source / Optics

- Unique magnetic mounting of luminaire head promotes easy, full 360° rotational aiming, and allows toolless drop down of head for easy access to change optics, lens accessories and driver service.
- Precision engineered dual axis cam for vertical tilt aiming up to 36° allows luminaire to remain centered in aperture reducing beam clipping
- 3 beamspreads available - 20°, 28° and 40°
- Up to 965 delivered lumens
- <2 MacAdam Steps (<2SDCM) for fixed white
- 90 CRI , 60+ R9 Standard- 95 CRI 90+R9 Optional with Ambient Dim
- 2700, 3000, 3500, 4000K and Ambient Dim (3000k-1900k)
- Lifetime: L87B3>55,000 hours at 40°C Ambient

Housing

- Heavy gauge aluminum for new construction or remodel
- IC Rated / Airtight Housing approved for use in direct contact with insulation – Chicago Plenum Available
- Approved for 8 (4-in / 4-out) #12 AWG conductors rated for 90°C through wiring
- Listed – Damp or wet with shower trim
- Fixture supports CA Title 24 compliance to JA8 requirements with Airtight Housing

Driver And Control

- Phase, 0-10, DALI, Ecosystem or Wireless Control
- Flicker free to IEEE 1789-2015 available
- Prewired and integral to housing
- Universal 120-277v

Ordering Codes

PROJECT:

SPECIFIER:

DATE:

TYPE:

QUANTITY:

Ordering Code Example: CRV4D-RA-DR-Z-AP-C20-35-20-E2-P16-91A-97L-CP-LR

FIXTURE	APERTURE	TRIM	MOUNTING	SOURCE / WATTS	CCT	BEAM	DRIVER / CONTROL	TRIM FINISH	LENS ACCESSORIES	ACCESSORIES
CRV4D-RA										
Cor-Vet 4" Round Adjustable Downlight with Rivet head	DR CorVet Deep Regress	Flanged Trims	Flanged Housings	Citizen	27 2700K	20 Spot	C1 0-10 1.0%, UNV (120-277V) linear	W White Paint	Aperture Lens	CP Chicago Plenum
	OR CorVet Open Regress	F Flanged Trim	U Universal - Non-IC Housing	C7 ● ● 9W 696Lm* 90+CRI, 60+R9	30 3000K	28 Narrow Flood	C2 ELV/Triac 1.0%, (120V) linear	B Black Paint	91A Solite	EM Emergency Pack
	FL CorVet Flat	FS Flanged Shower Trim*	AU ● ● Universal IC/Airtight*	C11 ● ● 13W 965Lm* 90+CRI, 60+R9	35 3500K	40 Flood	EldoLED	D Wood*	93A Frosted	EMP Emergency Pack with phase cut control system utilizing C1 driver
		(for mounting choose from Flanged Housings)	Flangeless Housings	Ambient Dim™	40 4000K		E1 0-10 0.1%, UNV (120-277V) log	PXX Specialty Paint Color*	XXA Other Aperture Lens Treatments*	EM Emergency Pack with phase cut control system utilizing C1 driver
		Flangeless Trims	P Plaster - Non-IC Housing	A9 ● ● 10W 547Lm* 95+CRI, 90+R9 3000 to 1900k	AD 3000-1900K		E2 DALI-2 0.1%, UNV (120-277V) log	P01-P15	Reflector (lamp) Media	Controls
		Z Flangeless Trim	AP ● ● Plaster IC/Airtight*	A11 ● ● 12W 629Lm* 95+CRI, 90+R9 3000 to 1900k			E3 0-10 0.1%, UNV (120-277V) linear	C Custom/RAL Color**	91L Solite	LR Lutron Wireless RF PowPak
		ZS Flangeless Shower Trim*	PM Panel Mount	● ● Supports CA Title 24 Compliance to JA8			E4^ DMX 0.1%, UNV (120-277V) Universal DMX Driver/Controller RGBW-DMX		93L Frosted	ATH Lutron Athena Wireless Node
		(for mounting choose from Flangeless Housings)	APM ● ● Panel Mount Airtight/IC*	* Based on Rivet 20° beam			^ INCLUDES DMX/RDM COMPATIBLE DRIVER WITH BUILT-IN DECODER - CONTROLLER BY OTHERS		97L Black Hexcel Louver	Must be used with E2 driver
		* Aperture Lens Required	● ● Supports CA Title24 compliance	All values based on Rivet photometry. Deep Regress and Flat apertures will experience beam clipping. Contact factory if exact photometry is required.			Lutron		XXL Other reflector (lamp) media*	CA Casambi Wireless BLE to be paired with driver
							LD Digital Ecosystem 1.0%, UNV (120-277V) ECO Hi-Lume SoftOn/Fade-to-Black LDE1	* Wood "D" selection to be used with Z trim and PM mounting - Refer to Wood Trim Guide	1 piece of media for aperture opening and 2 pieces for lamp (reflector) can be selected.	
							LP Digital Ecosystem 0.1%, UNV (120-277V) ECO Premier Hi-Lume SoftOn/Fade-to-Black, PEQ0, 20W max	** Refer to Finish Guide	*See Lens Accessory Guide	

Core trims and mountings with Rivet light engine and adjusting
Adjustable Recessed Accent/Downlight

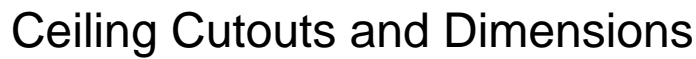

Round Flangeless Housing

Plaster Mount (P/AP)

Hanger Bar Detail



Flanged Mount (U/AU)

Round Flangeless Housing

Panel Mount (PM/APM)

Panel Mount Detail



Cor-Vet 4" Round Adjustable Downlight (102mm)

Core trims and mountings with Rivet light engine and adjusting
Adjustable Recessed Accent/Downlight



Photometric Table

All data is based from goniometer measurements of production representative Rivet product. The Rivet head is common to both fixtures and will have similar photometrics. The Core Deep Regress and Flat apertures will experience additional beam clipping. Contact factory if photometry of a particular combination is required. All lumen values can vary +/- 10% from LED manufacturer rated flux range. Measurements at 3000 CCT and Ambient Dim at full output.

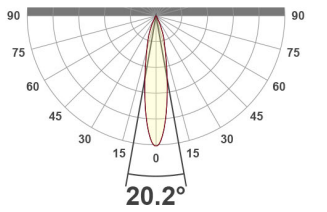
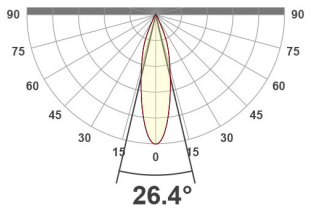
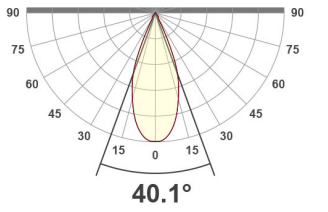
ROUND Beamspreads		20°				28°				40°			
Source	System watts (W)	Delivered Lumens (lm)	Lumens/ Watt	Peak CD	10% Field	Delivered Lumens (lm)	Lumens/ Watt	Peak CD	10% Field	Delivered Lumens (lm)	Lumens/ Watt	Peak CD	10% Field
Citizen C7	9	696	82	3520	48°	632	74	2101	52°	644	76	1143	54°
Citizen C11	13	965	77	4962	48°	875	69	2918	52°	888	70	2046	54°
Ambient Dim A9	10	547	54	2145	50°	484	48	1358	54°	514	51	1166	54°
Ambient Dim A11	12	629	52	2470	50°	565	47	1603	54°	592	49	1341	53°
CCT Multiplier		Beam angle				Beam angle				Beam angle			
CCT	Citizen												
2700	0.95												
3000	1.00												
3500	1.02												
4000	1.03												

ISO cd Plots based upon C11 Source. Refer to photometry tab on product page for exact ISO cd plot and IES files.

Color Data

All data is based from goniometer measurements of production representative product. All lumen values can vary +/- 10% from LED manufacturer rated data range. Measurements at 3000 CCT

Citizen Sources - C7 and C11

- <2 MacAdam Ellipse (<2 SDCM)
- 90+ CRI and RF
- 60+R9, Hue Bin 1

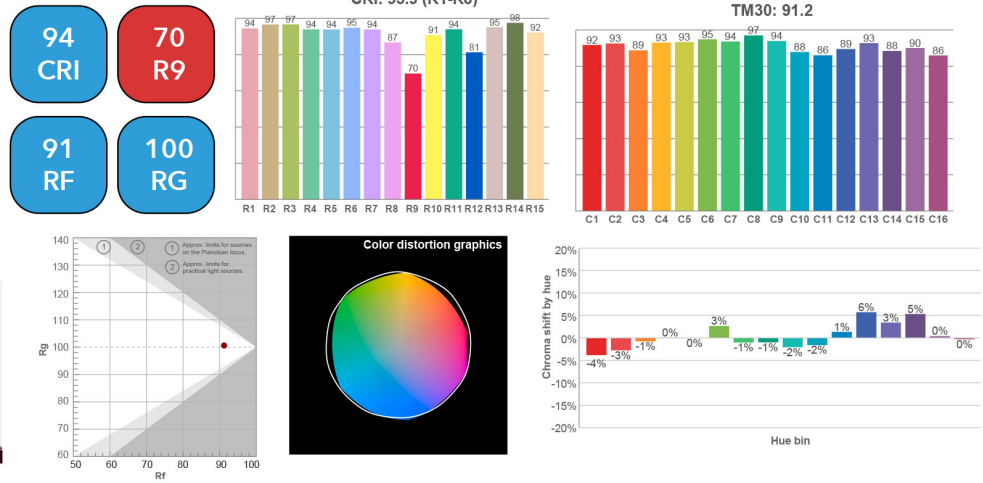

Ambient Dim Source A9, A11 (AD - 3000k to 1900k)

- <3 MacAdam Ellipse (<3 SDCM)
- 95+ CRI and RF
- 90+R9, Hue Bin 1
- Follows Black Body Locus through dimming range

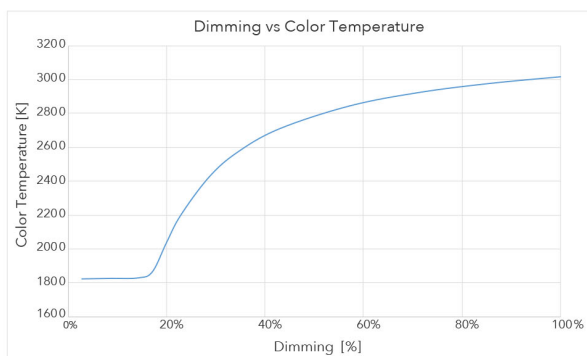

3000 CCT Full Output



1850 CCT 5% Output

